

Kit 1609

PERODUA Alza, 5-dr MPV, 09–

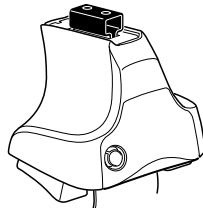

480R Rapid Traverse
754 Rapid System

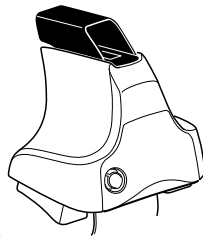
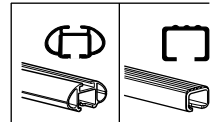

480 Traverse



480R Rapid Traverse x4
754 Rapid System x4

480 Traverse

- Bar (top): x2
- Bar (middle): x2
- Nut (top): x2 (23 mm)
- Nut (middle): x2 (23 mm)
- Washer (top): x1 (17 mm)
- Washer (middle): x2 (23 mm)
- Bolt (top): x4
- Bolt (middle): x2
- Cap nut (top): x4
- Cap nut (middle): x4
- Bar (right): x2

- Bracket (left): 1109 x2
- Bracket (left): 1110 x2
- Bracket (right): 120 x1
- Bracket (right): 121 x1
- Bracket (right): 162 x2
- Diagram: x1

Kit

1

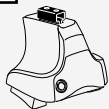

480R Rapid Traverse
754 Rapid System



480 Traverse

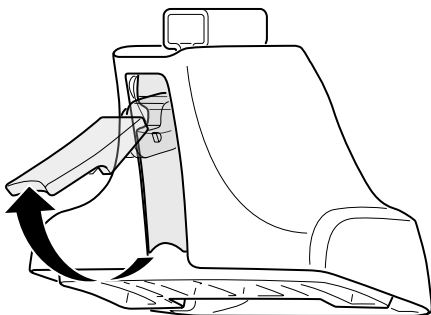

2



480R Rapid Traverse
754 Rapid System



480 Traverse

+

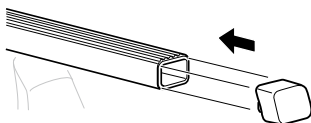
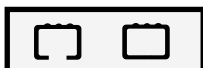
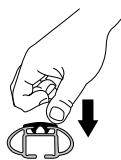
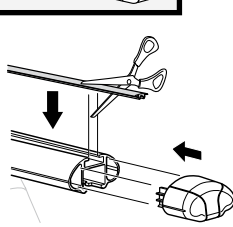
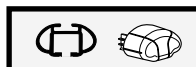
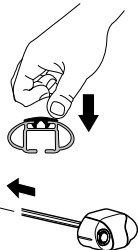
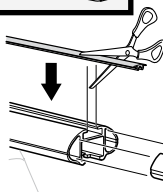
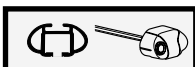
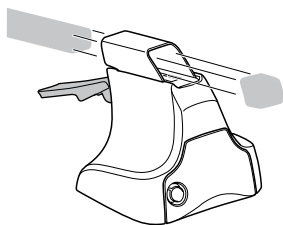
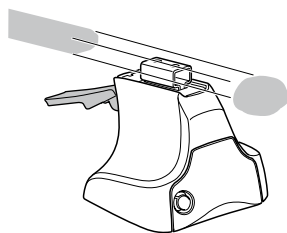

3

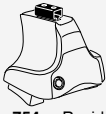

754 Rapid System

1

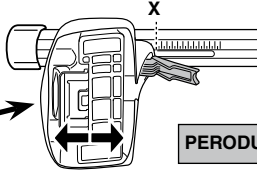
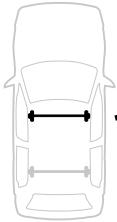

2

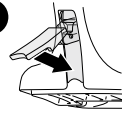

PERODUA Alza, 5-dr MPV, 09-

X

37

1

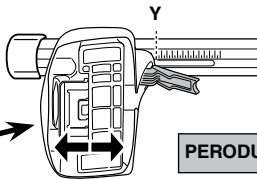
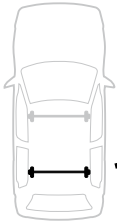

2

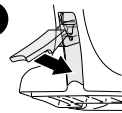

PERODUA Alza, 5-dr MPV, 09-

Y

36



480R Rapid Traverse



480 Traverse

1

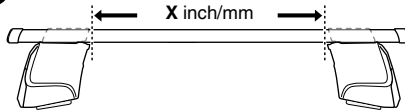

2

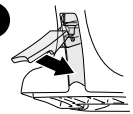

PERODUA Alza, 5-dr MPV, 09-

X inch

X mm

40 1/4"

1022 mm

1

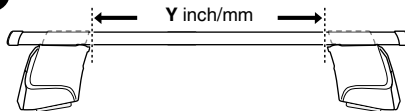

2

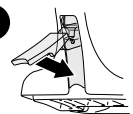

PERODUA Alza, 5-dr MPV, 09-

Y inch

Y mm

39 3/4"

1012 mm

4



480R Rapid Traverse
754 Rapid System



480 Traverse

PERODUA Alza, 5-dr MPV, 09-

121



1109



120

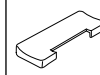

1109



162



1110



162

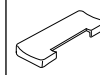

1110

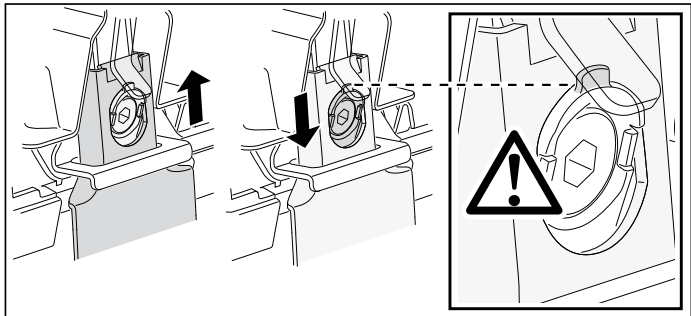
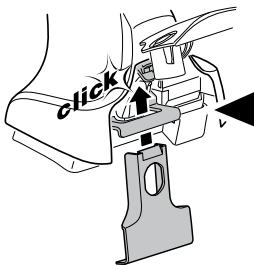
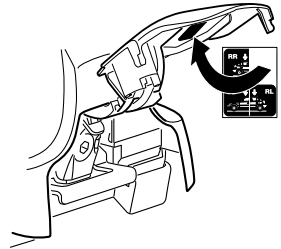
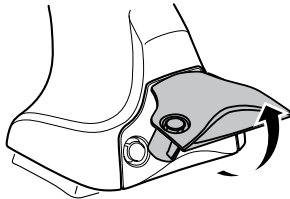
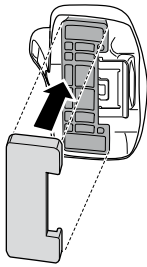

5



	X mm	Y mm	X inch	Y inch
PERODUA Alza, 5-dr MPV, 09-	470 mm	700 mm	18 1/2"	27 1/2"

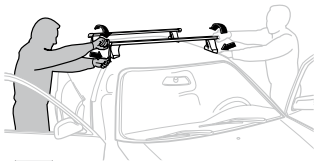
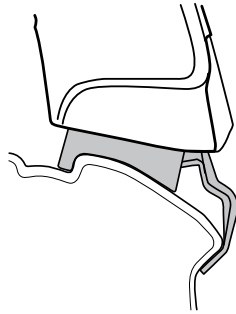
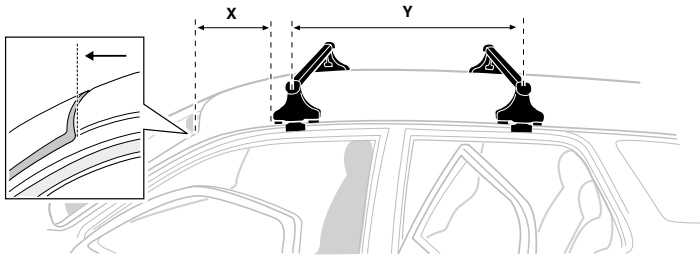

- | | | | |
|--------------|---|------------|---|
| GB/US | Tighten alternately | CZ | Pokrétla bagažníka dokřečaj dokřečaj naprzemiennie. |
| D | Die Schrauben abwechselnd anziehen | SK | Dofahujte striedavo |
| F | Serrer alternativement chaque côté | SLO | Privijajte izmenično. |
| NL | Afwisselend aan de linker- en de rechterkant aandraaien | HR | Naizmjenično zategniti |
| I | Alternare il serraggio delle viti | HU | Egymástól függetlenül szorítandó |
| E | Apretar alternativamente | GR | Σφιγγείτε εναλλάξ |
| PT | Aperte alternadamente | TR | Dönüşümlü sıkın |
| S | Dra åt växelvis | 中文 | 交替拧紧 |
| FIN | Kierrä vuorotellen | 한국어 | 번갈아 가며 조이십시오. |
| EST | Pinguldage vaheldumisi | 日本語 | 交互に締め付けてください。 |
| LAT | Pievelciet pamīšus | ไทย | ขันในแบบสลับ |
| LIT | Užsukinėkite pakaitomis | | |
| PL | Śruby dokřečaj naprzemiennie | | |
| RU | Затягивайте попеременно | | |

6

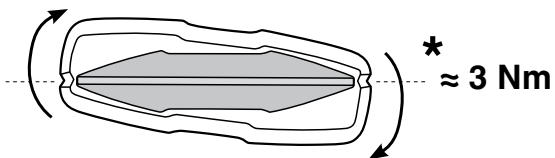
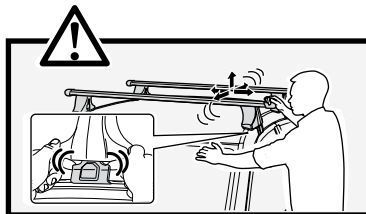
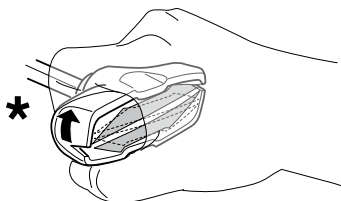
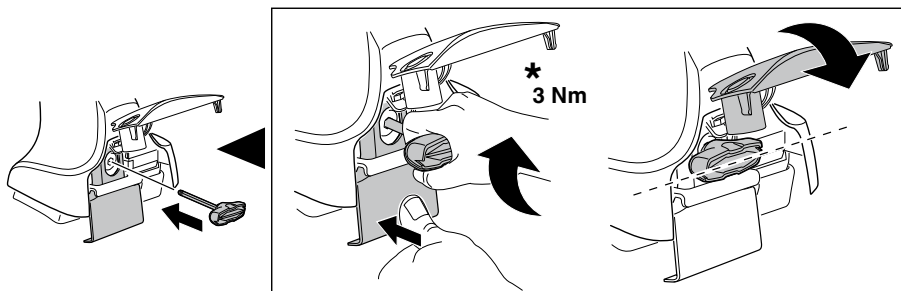
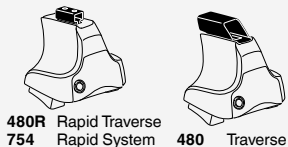

7

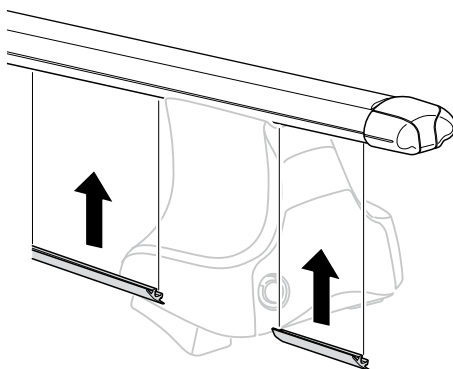
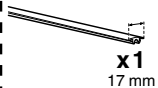

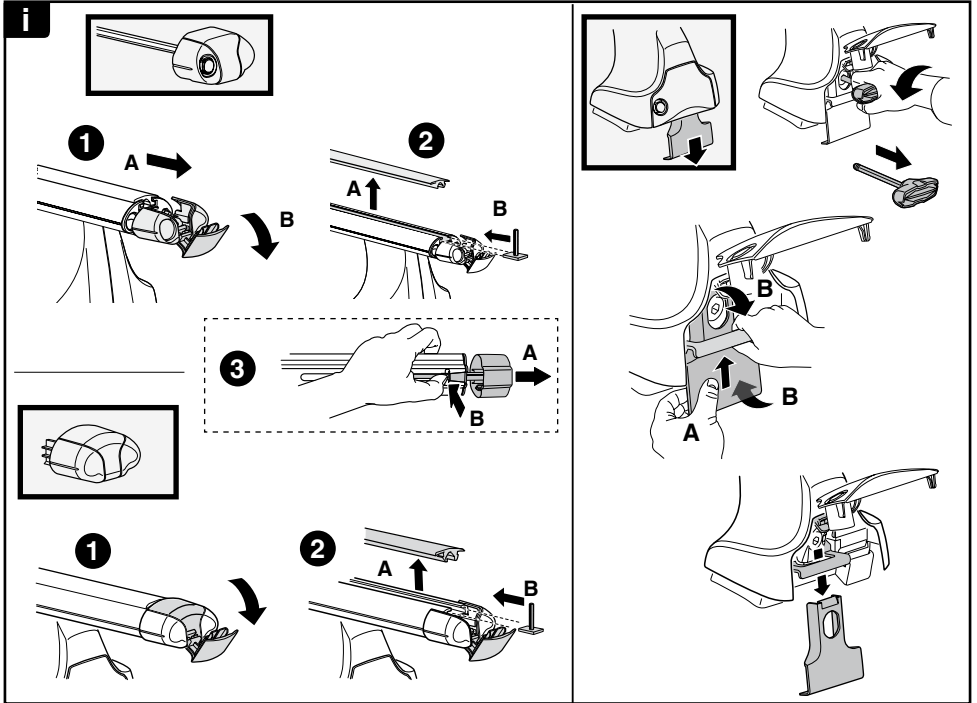
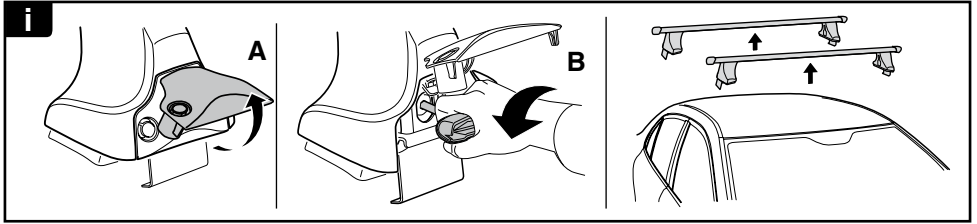

THULE
SWEDEN
**ONE
KEY
SYSTEM**

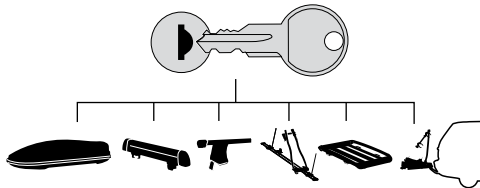

- 544** (x4)
- 596** (x6)
- 588** (x8)
- NA **510** (x10)
- EUR **452** (x12)
- ASIA

